

Exploded View

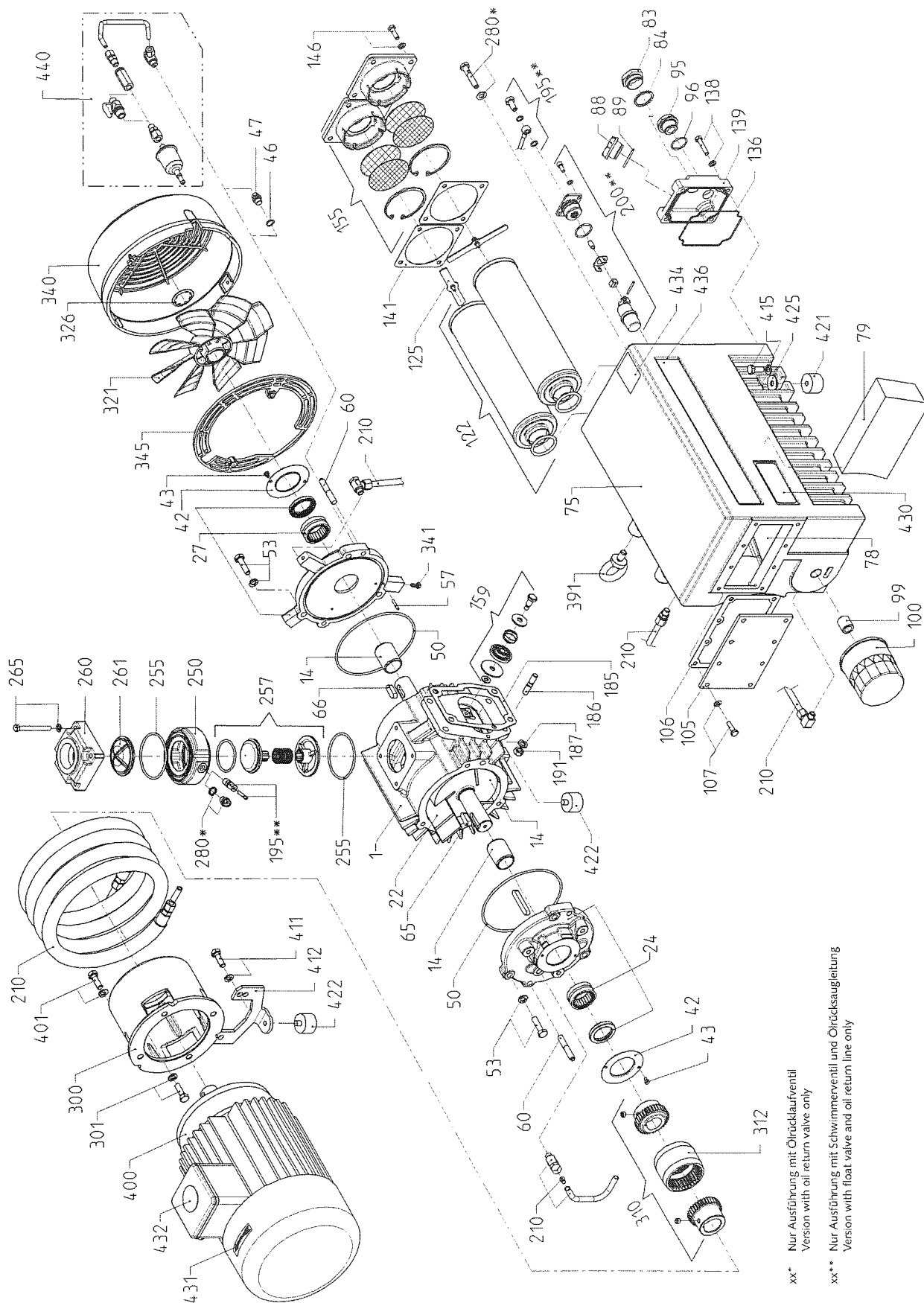

xx* Nur Ausführung mit Ölrücklaufventil
Version with oil return valve only

xx** Nur Ausführung mit Schwimmerventil und Ölrücksaugleitung
Version with float valve and oil return line only

Spare Parts

Note: When ordering spare parts or accessories acc. to the table below please always quote the type and the serial no. of the vacuum pump. This will allow Busch service to check if the vacuum pump is compatible with a modified or improved part.

This parts list applies to a typical configuration of the vacuum pump RA 0063 - 0100 F. Depending on the specific order deviating parts data may apply.

Pos.	Part	Qty	Part no.
1	Cylinder (RA 0063 F)	1	0223 137 495
1	Cylinder (RA 0100 F)	1	0223 136 239
14	Rotor with shaft sleeves (RA 0063 F)	1	0950 108 821
14	Rotor with shaft sleeves (RA 0100 F)	1	0950 108 822
22	Vane (RA 0063 F)	3	0722 000 330
22	Vane (RA 0100 F)	3	0722 000 360
24	Cylinder cover A-side, complete	1	0952 137 028
27	Cylinder cover B-side, complete	1	0952 139 111
42	Supporting washer	2	0391 000 601
43	Hex head screw	4	0410 000 023
46	Seal ring	1	0484 000 029
47	Plug	1	0415 000 002
50	O-ring	2	0486 000 539
53	Hex head screw/lock washer	6	0947 127 452
57	Parallel pin	1	0437 138 870
60	Taper pin (RA 0063 F)	4	0437 104 545
60	Taper pin (RA 0100 F)	4	0437 000 074
65	Parallel key	1	0434 000 044
66	Parallel key	1	0434 000 044
75	Oil separator (version with float valve and oil return line)	1	0266 137 792
75	Oil separator (version with oil return valve)	1	0266 138 129
78	Expanded metal	1	0534 101 306
79	Demister	1	0534 101 308
83	Sight glass	1	0583 000 001
84	Gasket	1	0480 000 271
88	Plug	1	0710 000 009
89	O-ring	1	0486 000 590
95	Plug	1	0710 000 010
96	O-ring	1	0486 000 505
99	Nipple	1	0461 000 061
100	Oil filter	1	0531 000 002
105	Cover	1	0360 108 294
106	Gasket	1	0480 108 718
107	Hex head screw/lock washer	8	0947 127 445
122	Exhaust filter with o-ring	1	0992 130 806
125	Filter spring	2	0947 000 720
136	Round gasket-service cover	1	0486 114 368
138	Hex head screw/lock washer	4	0947 127 447
139	Service cover	1	0247 113 773
141	Gasket	2	0480 000 112
146	Hex head screw/lock washer	8	0947 127 445
155	Exhaust cover plate, complete	2	0947 125 296

159	Exhaust valve, complete	2	0916 126 769
185	Gasket	1	0480 000 150
186	Stud bolt	4	0412 104 730
187	Spring lock washer	4	0432 000 012
191	Hex nut	4	0420 000 035
195	Oil return line, complete	1	0946 139 103
200	Float valve, complete	1	0947 138 417
210	Oil supply (RA 0063 F), complete	1	0913 117 027
210	Oil supply (RA 0100 F), complete	1	0913 135 939
250	Inlet flange, lower part	1	0246 101 999
255	O-ring	2	0486 000 526
257	Valve insert, complete	1	0916 125 491
260	Inlet flange	1	0246 000 541
261	Screen	1	0534 000 018
265	Hex head screw/lock washer	4	0947 127 453
280	Oil return valve, complete	1	0946 139 037
300	Motor flange	1	0247 107 490
301	Hex head screw/lock washer	3	0947 127 451
310	Coupling, complete, for 3phase motor, motor shaftØ 24 mm	1	0510 000 014
310	Coupling, complete, for 3phase motor, motor shaftØ 28 mm (not for motor 0621 129 389)	1	0510 000 015
310	Coupling, complete, for motor 0621 129 389	1	0510 000 037
310	Coupling, complete, for AC motor, motor shaftØ 24 mm	1	0510 000 507
310	Coupling, complete, for AC motor, motor shaftØ 28 mm	1	0510 000 506
310	couplings for other motors	1	on request
312	Coupling sleeve, for AC motor (not for motor 0621 129 389)	1	0512 000 004
312	Coupling sleeve, for motor 0621 129 389	1	0512 000 005
312	Rubber coupling insert, for AC motor	1	0512 000 109
315	Protection clip (RA 0063 F)	3	0710 109 012
321	Axial flow fan (RA 0063 F)	1	0524 121 854
321	Axial flow fan (RA 0100 F)	1	0524 108 653
326	Locking ring	1	0432 000 380
340	Fan cover	1	0713 000 108
341	Tapping screw	3	0416 120 665
345	Protective grid	1	0713 108 129
391	Eye bolt	1	0416 000 023
400	3phase motor 1.5 kW, 230/400 V, 50 Hz, 1500 min-1, shaft Ø24 x 50 mm	1	0616 127 187
400	3phase motor 1.8 kW, 190-210/380-420 V, 50 Hz, 1500 min-1; 2.2 kW, 190-240/380-480 V, 60 Hz, 1800 min-1, shaft Ø28 x 60 mm	1	0620 129 388
400	3phase motor 2.2 kW, 230/400 V, 50 Hz, 1500 min-1, shaft Ø28 x 60 mm	1	0620 127 188

400	3phase motor 2.5 kW, 190-210/380-420 V, 50 Hz, 1500min-1; 3.0 kW, 190-240/380-480 V, 60 Hz, 1800 min-1, shaft Ø28 x 60 mm	1	0621 129 389
400	3phase motor 3.0 kW, 230/400 V, 50 Hz, 1500 min-1, shaft Ø28 x 60 mm	1	0620 127 189
400	AC motor 1.8 kW, 220-240 V, 50 Hz, 1500 min-1, shaft Ø24 x 50 mm	1	0620 000 340
400	AC motor 2.0 kW, 220-240 V, 60 Hz, 1800 min-1, shaft Ø28 x 60 mm	1	0620 000 341
400	other motors	1	on request
401	Hex head screw/lock washer	2	0947 127 450
411	Hex head screw/lock washer	2	0947 127 451
412	Foot	1	0391 107 504
415	Hex head screw/lock washer	1	0947 127 450
421	Rubber foot	1	0561 000 001
422	Rubber foot	2	0561 000 030
425	Washer	1	0431 000 132
430	Nameplate	1	0565 102 562
431	Directional arrow	1	0565 000 003
432	Label before installation	1	0565 104 694
434	Label hot surface	1	0565 531 032
436	Label Busch R 5	1	0565 138 308
440	Gas ballast (optional)	1	0916 101 781
440	Gas ballast, adjustable (optional)	1	on request
—	Filter for gas ballast	1	0531 126 699
540	Air filter with paper cartridge (RA 0063 F, not shown, optional)	1	0530 000 002
—	Paper cartridge for air filter (RA 0063 F, not shown, optional)	1	0532 000 002
540	Air filter with paper cartridge (RA 0100 F, not shown, optional)	1	0530 000 003
—	Paper cartridge for air filter (RA 0100 F, not shown, optional)	1	0532 000 003
540	Air filter with polyester cartridge (RA 0063 F, not shown, optional)	1	0530 121 867
—	Polyester cartridge for air filter (RA 0063 F, not shown, optional)	1	0532 121 862
540	Air filter with polyester cartridge (RA 0100 F, not shown, optional)	1	0530 121 868
—	Polyester cartridge for air filter (RA 0100 F, not shown, optional)	1	0532 121 863
541	Double nipple (not shown, for air filter, optional)	1	0456 000 328
—	Bend (not shown, for horizontal air filter, optional)	1	0456 000 327

Spare Parts Kits

Spare parts kit	Description	Part no.
Service kit	oil filter, exhaust filter and pertinent seals	0992 106 214

Set of seals/gaskets	all necessary seals, except for the seal of the float valve	0990 106 211
Overhaul kit (RA 0063 F)	service kit, set of seals and all overhaul parts, except for the float valve and the seal of the float valve	0993 106 212
Overhaul kit (RA 0100 F)	service kit, set of seals and all overhaul parts, except for the float valve and the seal of the float valve	0993 106 213

Accessories

Accessories	Description	Part no.
Inlet air filter	RA 0063 F, inlet-side, vertical, with paper cartridge, to separate solids	0945 000 132
Inlet air filter	RA 0100 F, inlet-side, vertical, with paper cartridge, to separate solids	0945 000 134
Inlet air filter	RA 0063 F, inlet-side, horizontal, with paper cartridge, to separate solids	0945 000 133
Inlet air filter	RA 0100 F, inlet-side, horizontal, with paper cartridge, to separate solids	0945 000 135
Inlet air filter	RA 0063 F, inlet-side, vertical, with polyester cartridge, food proof, to separate solids	0945 121 873
Inlet air filter	RA 0100 F, inlet-side, vertical, with polyester cartridge, food proof, to separate solids	0945 121 875
Inlet air filter	RA 0063 F, inlet-side, horizontal, with polyester cartridge, food proof, to separate solids	0945 121 874
Inlet air filter	RA 0100 F, inlet-side, horizontal, with polyester cartridge, food proof, to separate solids	0945 121 876
Filter pressure gauge	for easy checking of the degree of clogging of the exhaust filter	0946 000 100
Vacuum regulating unit	to adjust the required working pressure; connection R 1 1/4 inch	0947 000 449
Gas ballast, complete	for the conveying of condensable vapours, with paper filter	0916 101 781
Gas ballast, adjustable, complete	for the conveying of condensable vapours, with paper filter and ball valve	on request
Motor safety switch	adjustment range: 1.6 – 2.4 A, 3 Ph.	0985 000 248
Motor safety switch	adjustment range: 2.4 – 4.0 A, 3 Ph.	0985 000 249
Motor safety switch	adjustment range: 4.0 – 6.0 A, 3 Ph.	0985 104 496
Motor safety switch	adjustment range: 6.0 – 10.0 A, 3 Ph.	0985 104 497
Motor safety switch	adjustment range: 10.0 – 16.0 A, 3 Ph.	0985 104 498
Motor safety switch	adjustment range: 10.0 – 16.0 A, 1 Ph.	0985 101 152